

Location Map

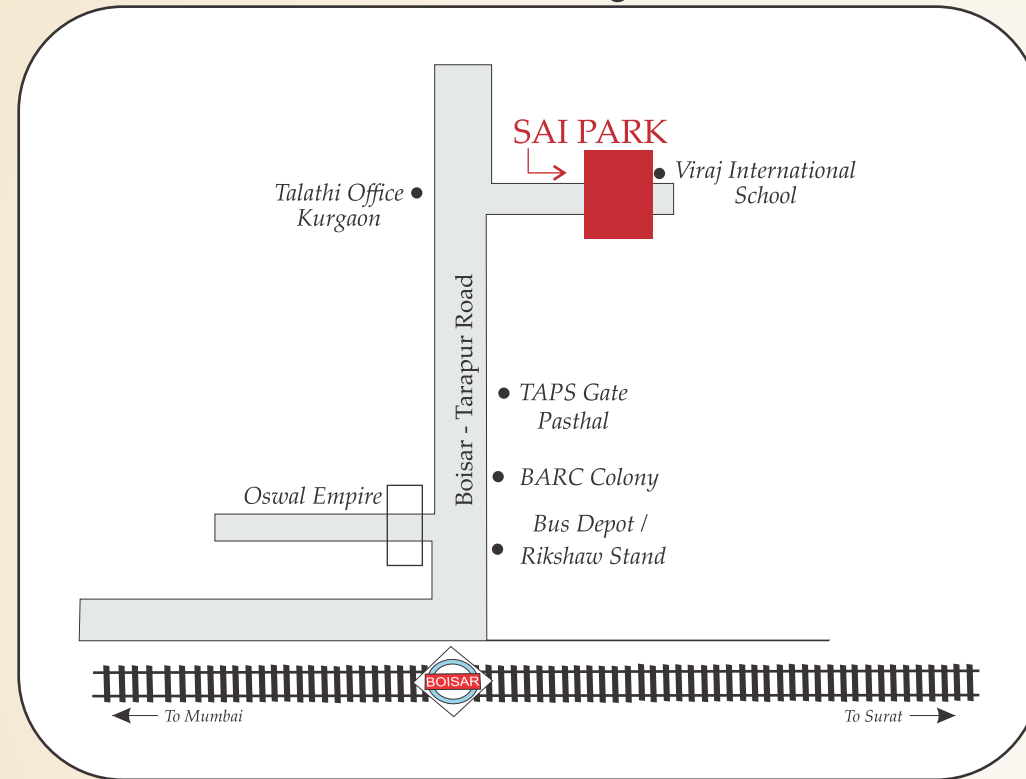

CONTACT

Mrs. Ekta Singh : 9209724516
Mr. Shailesh Doshi : 9821638950
Mr. Meet Doshi : 8828208856

Email : vinayamargroup@gmail.com

Website : www.amargroupofcompanies.com

This brochure is purely conceptual and not a legal offering. The Promoter/Architects reserve the right to add/delete/alter any detail/specification/elevation mentioned herein. The brochure is indicative of how the furniture can be arranged in the row house. No furniture of any nature is to be supplied to the flat purchaser by the developer.

For Bldg. No. 3 Wing B & C
Contact



AMAR
GROUP

A-63/101, Sector No. 1, Shanti Nagar,
Near Rly. Station, Mira Road (E)-401 107.
Tel : 2811 83 38 | 2810 5940

Site Address

“Sai Park”, Survey No. 27/2, Opp. Talathi Office,
Boisar - Tarapur Road, Kurgaon, Boisar (W).

Legal Advisor

M/s. K. A. Shanghavi & Co.
Vasai (W)

Architect

M/s. Vastu Shilp Associates
Palghar (W)

Structural Engineer

M/s. Jayshree Krishna Consultant
Borivali (W)

Vastu Plus

Mr. Nitien Parmar

Diagram Interiors

Mr. Hitendra Mistry

Visit once before purchasing your DREAM HOME...

Sai Park

reaching new heights...



Salient Features Of Projects

- Approved project of more than 200 flats /shops
- Elegant decorative entrance lobby
- Luxurious 1 & 2 bhk flats well planned as per vastu
- High standard construction with beautiful elevation
- Lush green landscaped garden with party lawn
- Children's play area
- Clubhouse facility for small functions
- Paved walkway with senior citizen benches
- Easy loan approval from all financial institutions / banks
- Adequate open space on all sides of the building
- Non polluted, calm & dignified environment



- Vitrified tiles with skirting in entire flat
- Granite kitchen platform with stainless steel sink with designer coloured glazed tiles
- Main door with classic brass fittings
- Granite door frames for bath / w.c. with full height designer coloured glazed tiles
- P.O.P cornish with spotlight in living room
- French styled windows with anodized 3/4" aluminum section with float glass
- Acrylic emulsion paint for inside wall
- Acrylic weather shield paint for external walls
- Concealed copper with branded switches & accessories
- Concealed plumbing fittings of reputed brand
- Loft tank provided for extra storage of water
- Checkered tile pavement in compound



Sai Park

reaching new heights...

“SAI PARK” a magnificent project consisting of four beautifully designed buildings at Boisar (west). Consisting of 1 & 2 bhk apartments filled with modern amenities & facilities that are breath taking.

“SAI PARK” is centrally located making it convenient for residents to reach markets, schools, colleges, hospitals, theaters etc., within no time. Once you enter “Sai Park” you find yourself in a perfect place called “DREAM HOME”...where you forget all your trials & troubles behind.

There are local trains, shuttle & memu trains that makes Boisar well connected to every place in Mumbai. Most long distance trains also stop at Boisar. With this it also has state transport buses for Thane, Bhiwandi, Wade & various other parts of Maharashtra.

This elegant enclave of impeccably laid out apartments is designed to enhance the good things of life while ensuring the smooth passage of its routine necessities.

Come experience the true meaning of reaching new heights...



The floor plan shows a 2-bedroom apartment with the following layout:

- Top Bedroom:** Labeled "BED 9'0" X 9'0\"", featuring a bed, a dresser, and a window.
- Kitchen:** Labeled "KITCHEN 7'0" X 7'0\"", containing a sink, a stove, and a refrigerator.
- Bathroom:** Labeled "BATH 6'0" X 4'0\"", equipped with a bathtub, toilet, and sink.
- W.C. (Toilet):** Labeled "W.C. 4'0" X 3'0\"", located adjacent to the bathroom.
- Bottom Bedroom:** Labeled "BED 9'0" X 9'0\"", featuring a bed, a dresser, and a window.
- Bottom Bathroom:** Labeled "BATH 6'0" X 4'0\"", equipped with a bathtub, toilet, and sink.
- Bottom W.C. (Toilet):** Labeled "W.C. 4'0" X 3'0\"", located adjacent to the bottom bathroom.

The entire floor plan is set against a large, stylized, light-colored swirl background.



Ground Floor Plan

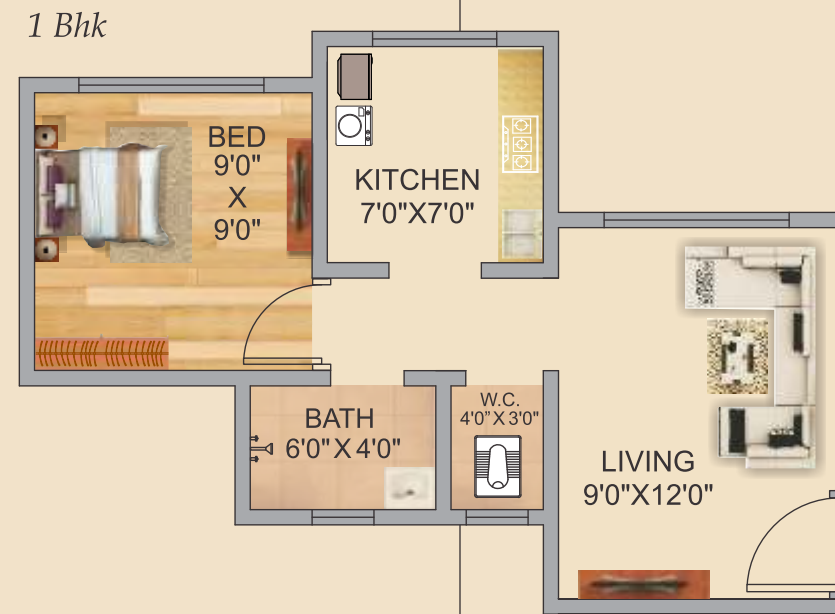

1 Bhk



2 Bhk



Typical Floor Plan